

**BACKBONE** 

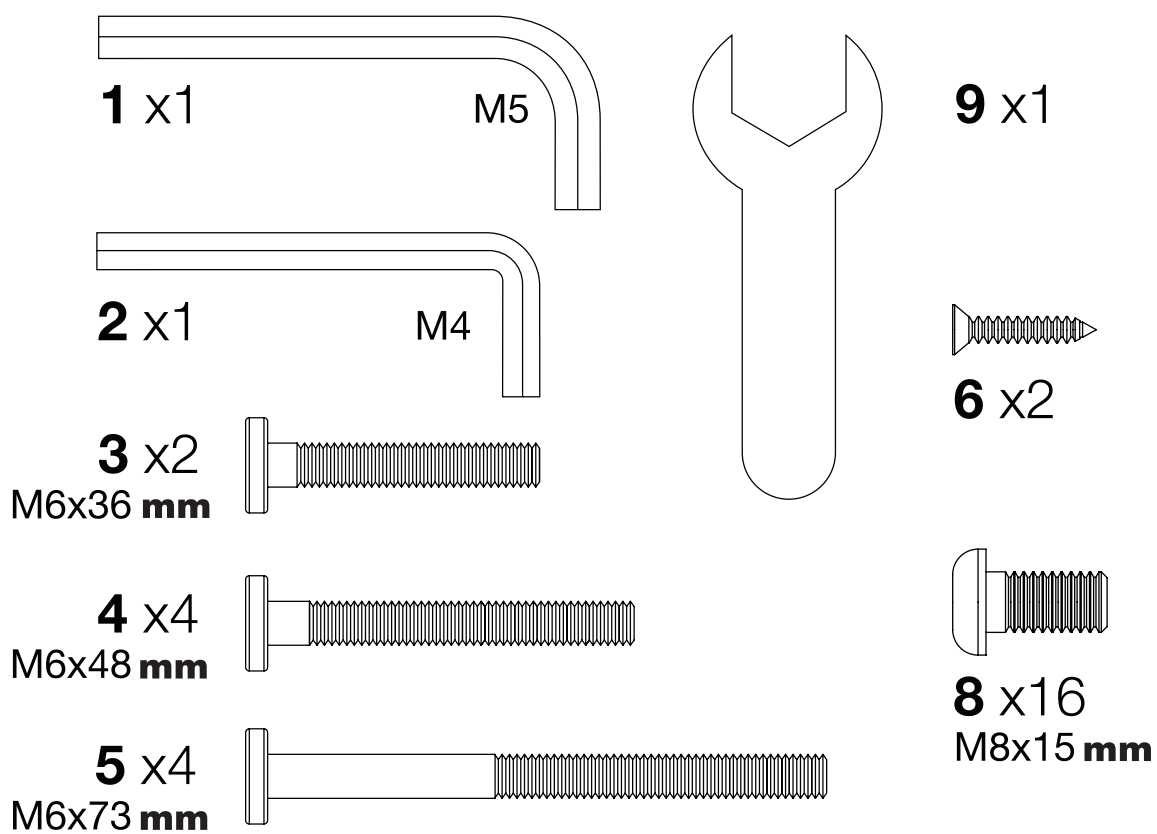

## STEP 1

Assemble the right and left frame

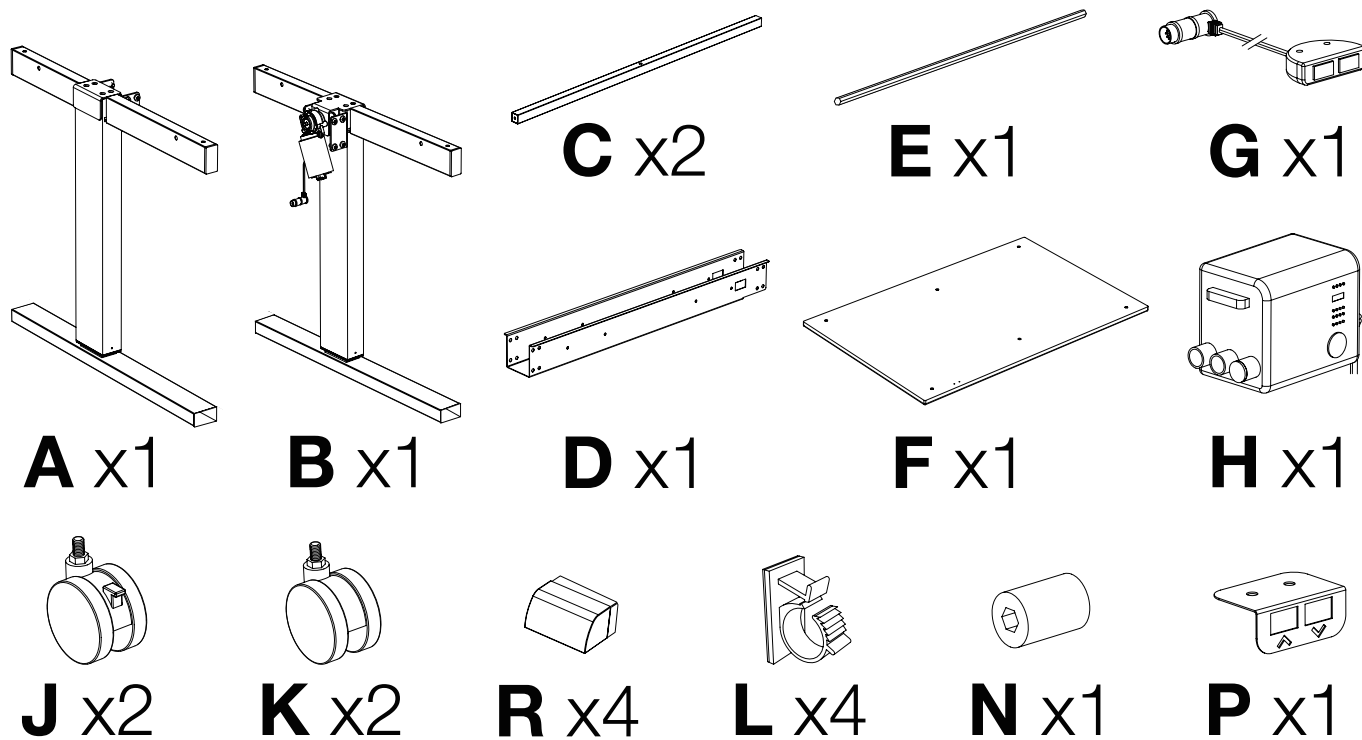
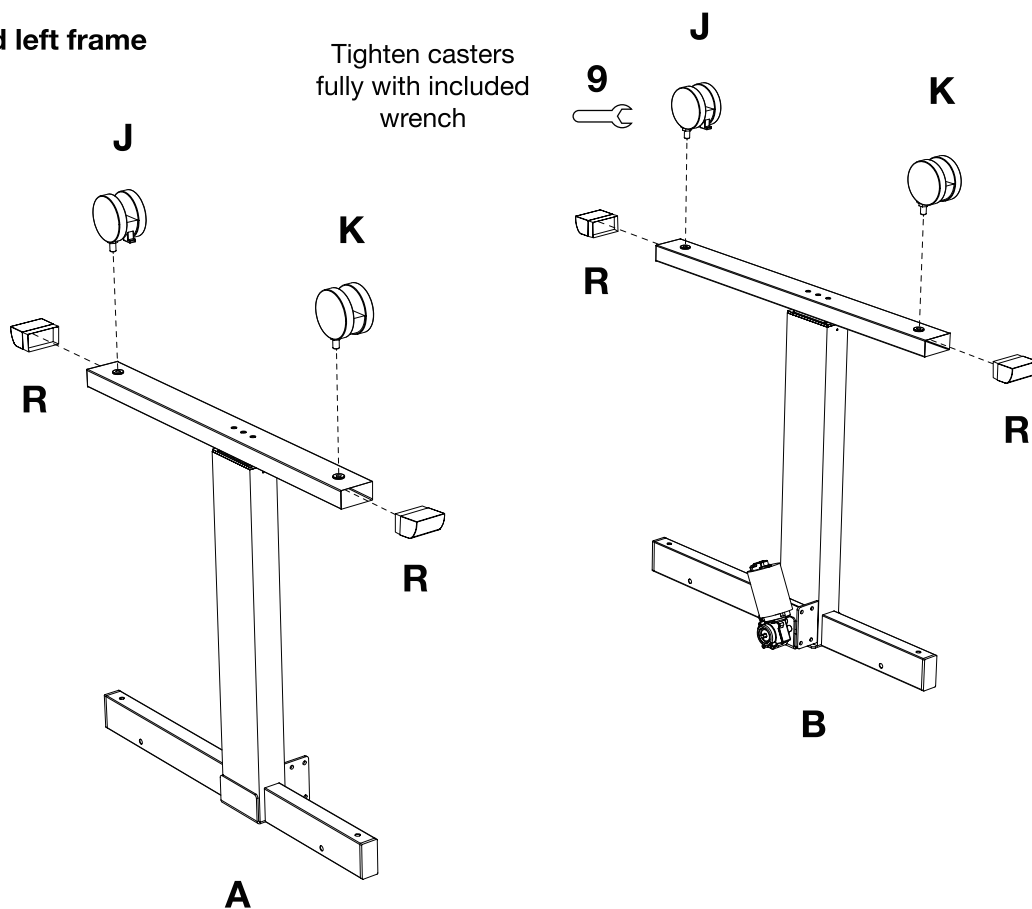

**Gather Parts:**  
A, B, J, K, R, 9

## STEP 2

Assemble the cross bars

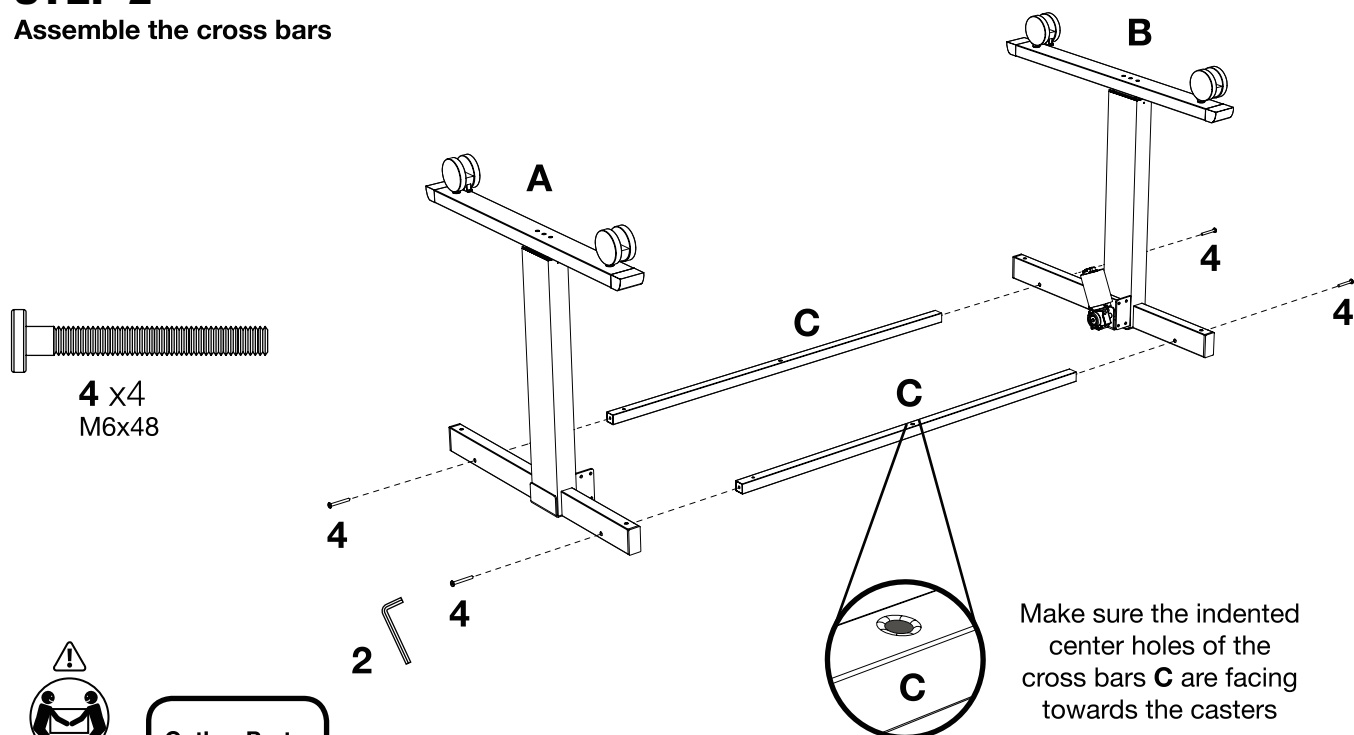

**Gather Parts:**  
C, 2

## STEP 3 Attach electric adjustment housing

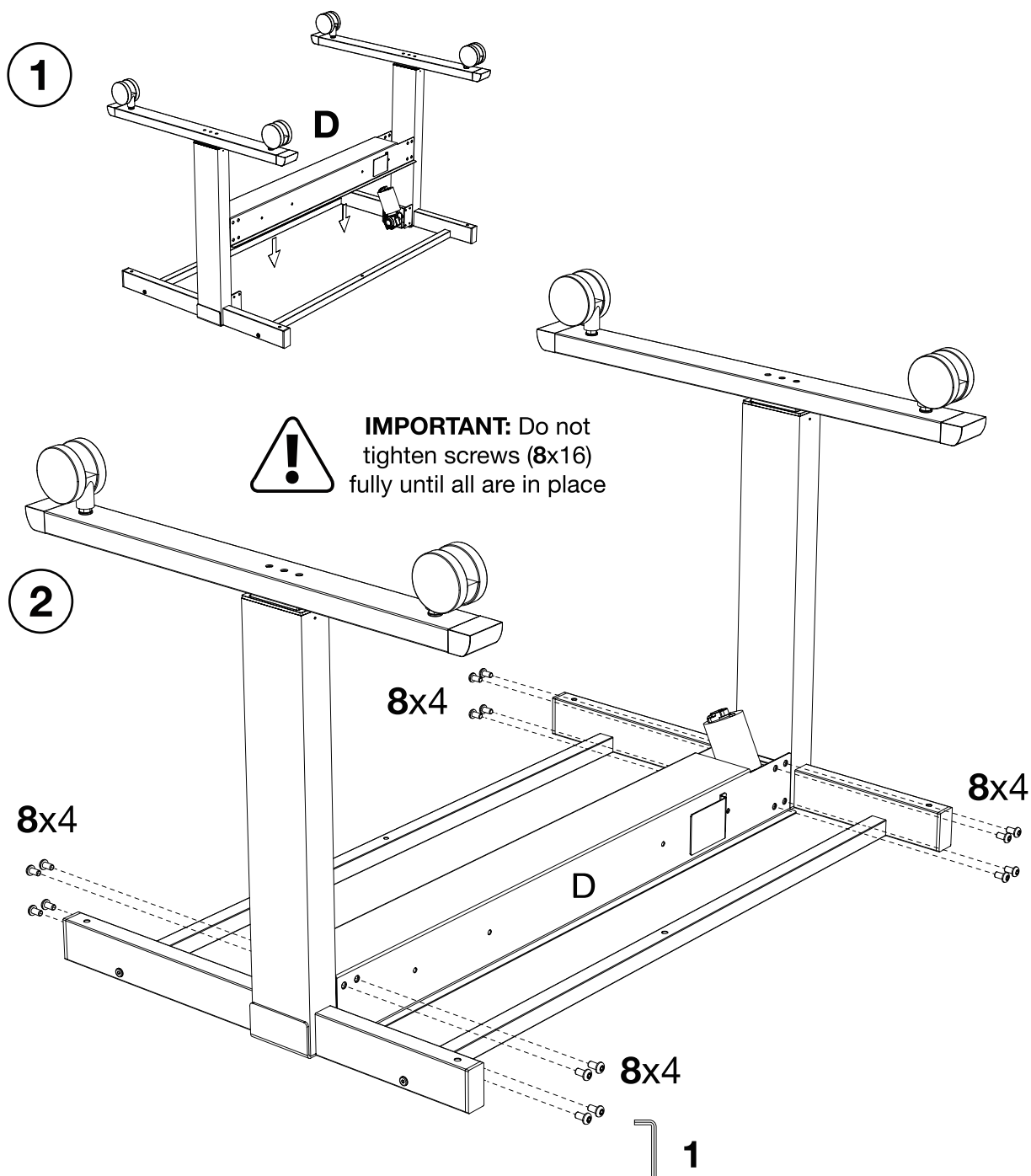

**Gather Parts:**  
D, 1

&

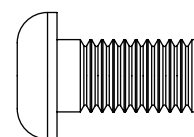

**8** x 16  
M8 15mm

## STEP 4 Flip desk upright and install optional electric

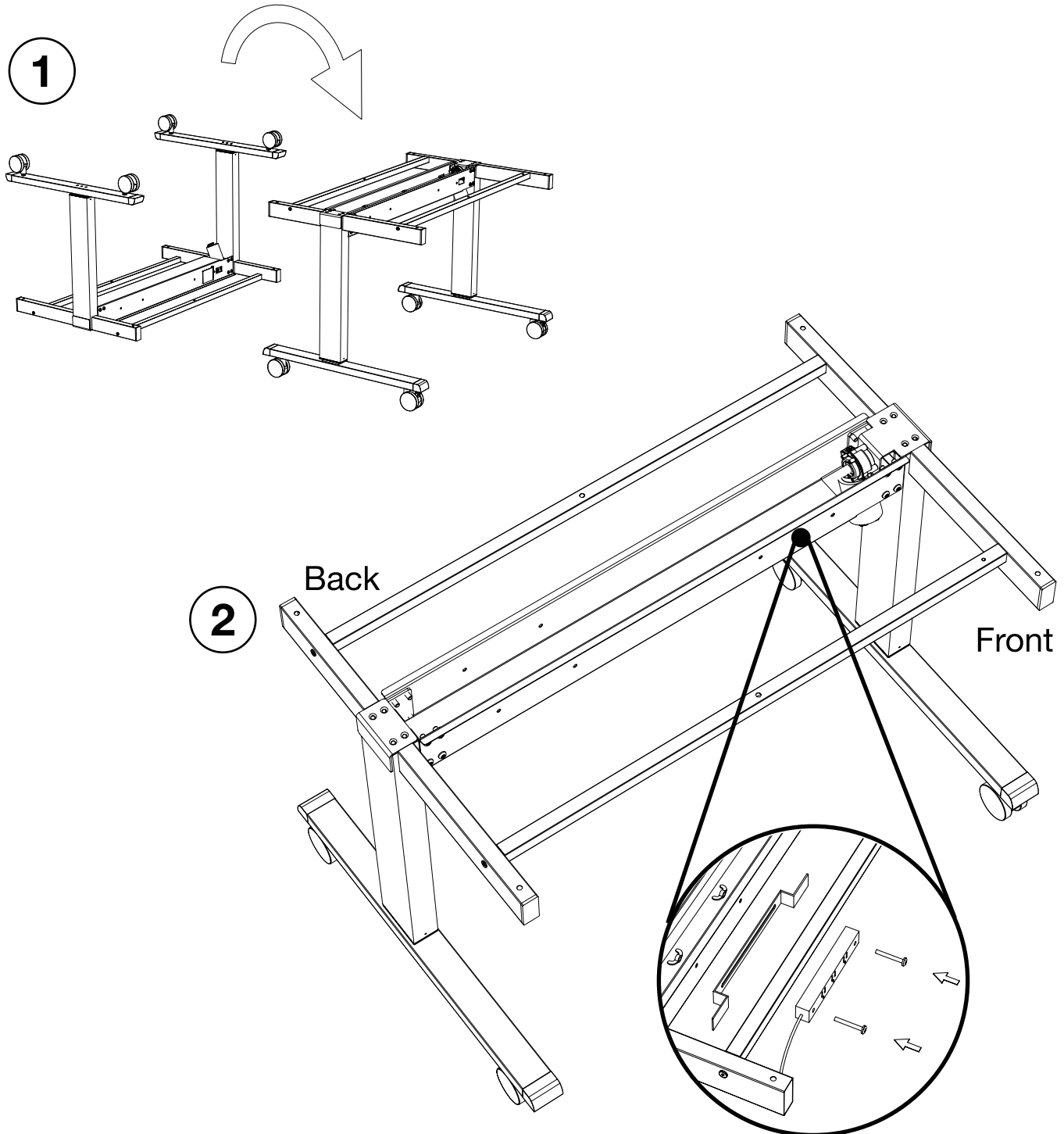

**IMPORTANT:** Install the **OPTIONAL** electric (**SOLD SEPARATELY**) before attaching the desk top to the frame.

## STEP 5 Install rotating cross bar

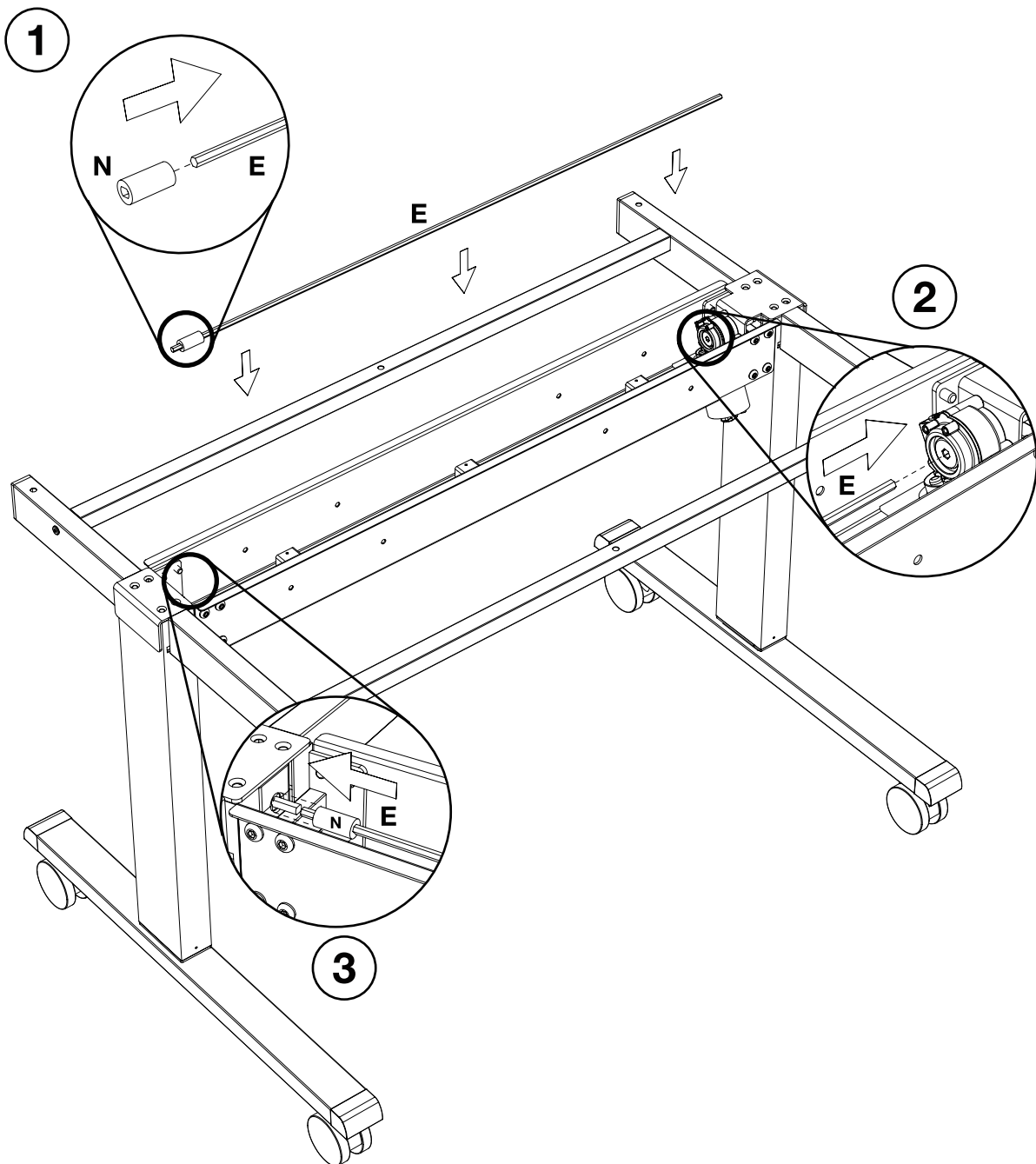

**Gather Parts:**  
N, E

## STEP 6 Mount power supply to unit

1

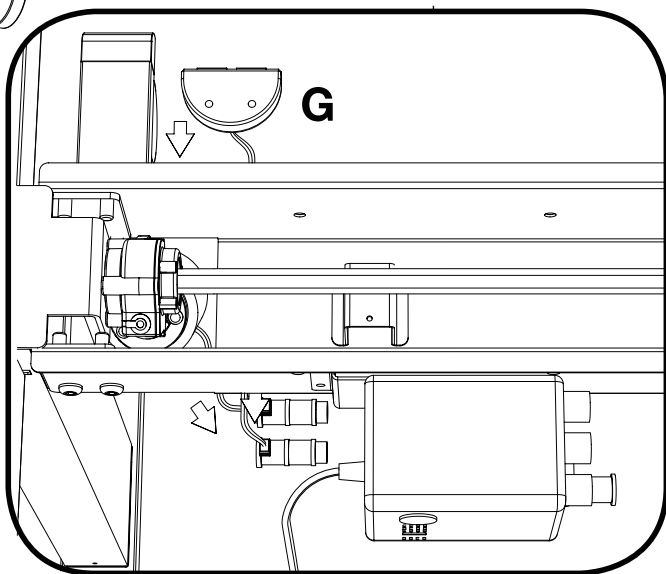
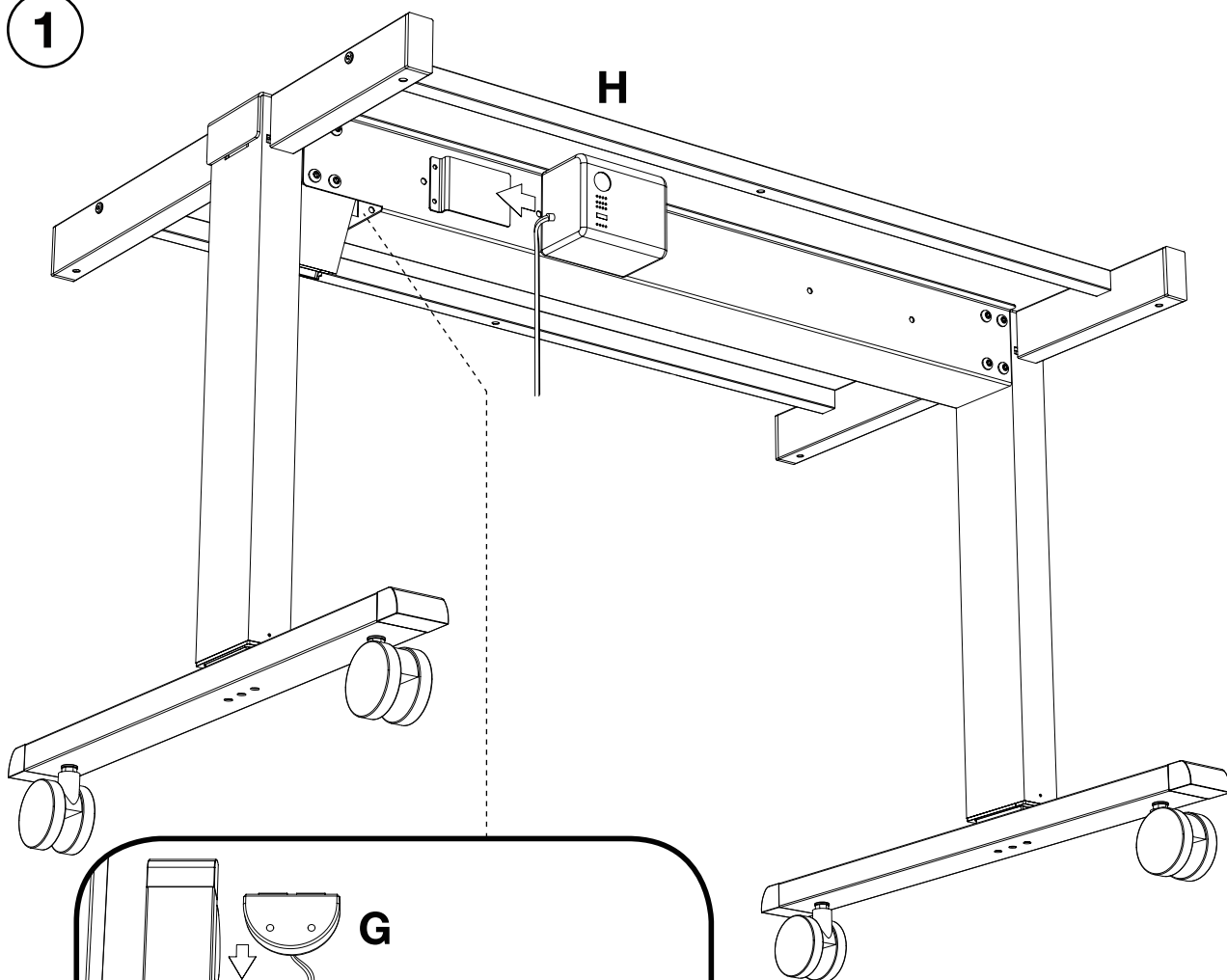

2

Feed the cords underneath electric adjustment housing. Use included cable clips to organize any extra cable length.

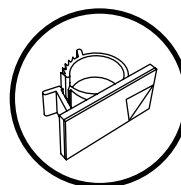

L x4

**Gather Parts:**  
G, H

## STEP 7 Plug in electrical cords to power supply

1

Attach the cable that is connected to the motor to the center plug. Make sure the pins line up correctly.

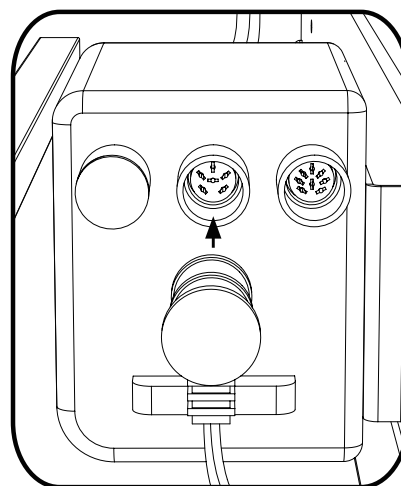
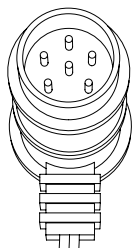

2

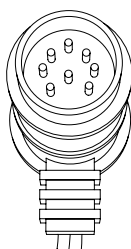
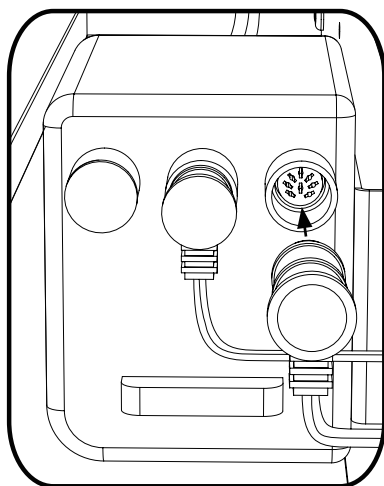

Attach the cable that is connected to the controller to the left plug. Make sure the pins line up correctly.

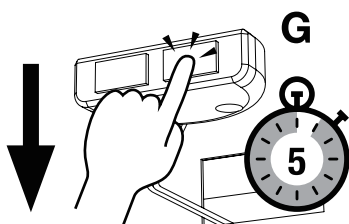

To set up the system, hold the right button until the unit is at its lowest position then wait for five (5) seconds. Also do this when a power outage occurs or if the unit has been unplugged.



## STEP 8 Attach the desk surface

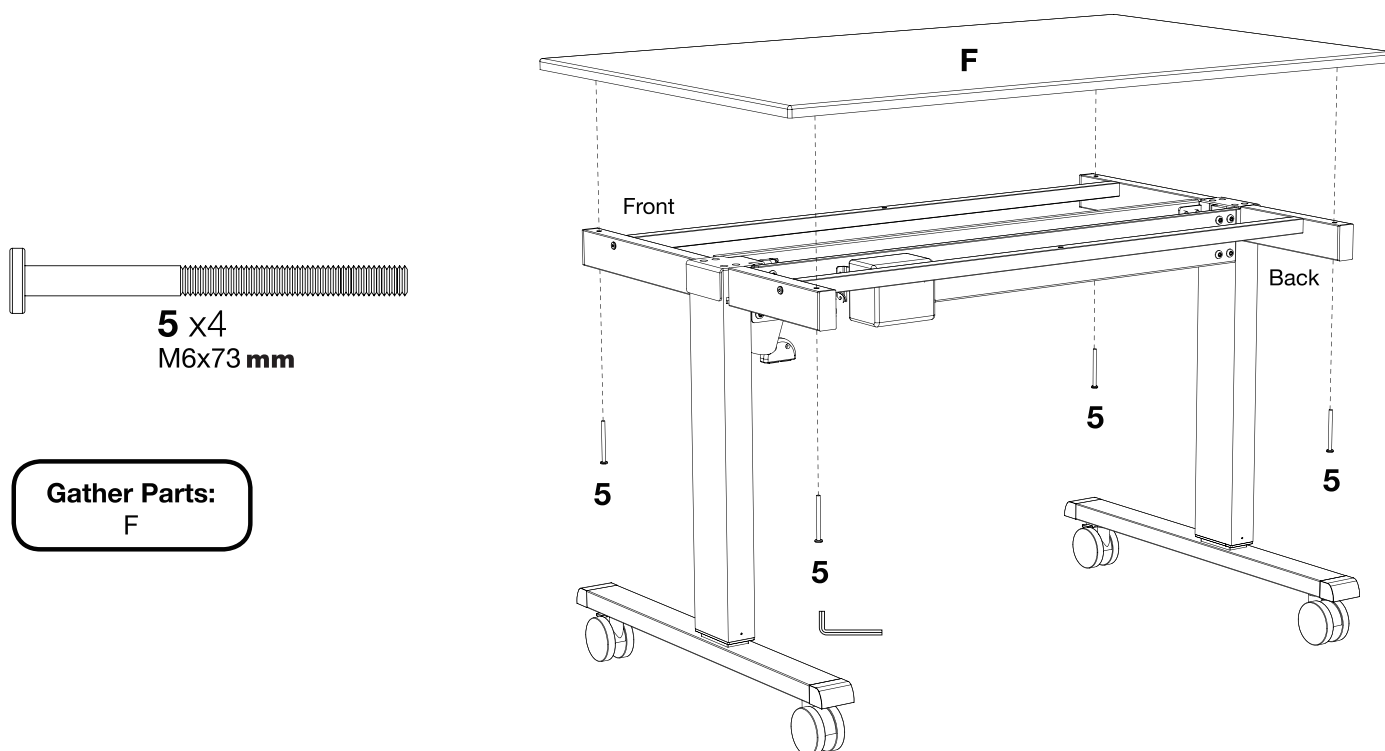

## STEP 9 Attach remaining bolts to the desk surface

